

# Technical data sheet

## Product features



### Cooking range water gas 2 zones

<b>Model</b>	<b>SAP Code</b>	00013585
--------------	-----------------	----------

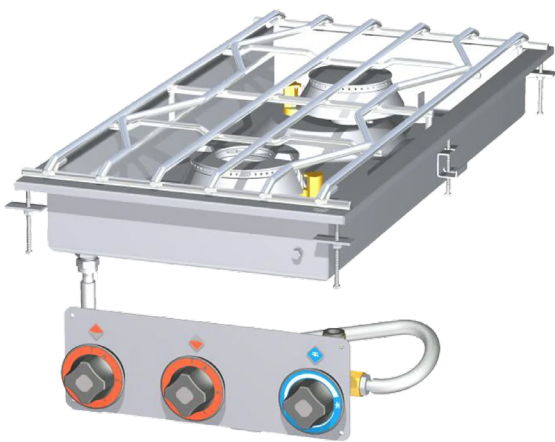

- Device type: Gas unit
- Power consumption of the zone 1 [kW]: 8,5
- Power consumption of the zone 2 [kW]: 5,5
- Ignition: Eternal flame
- Material: Stainless steel

<b>SAP Code</b>	00013585	<b>Power gas [kW]</b>	14.000
<b>Net Width [mm]</b>	400	<b>Number of zones</b>	2
<b>Net Depth [mm]</b>	800	<b>Power consumption of the zone 1 [kW]</b>	8,5
<b>Net Height [mm]</b>	120	<b>Power consumption of the zone 2 [kW]</b>	5,5
<b>Net Weight [kg]</b>	47.00		

# Technical data sheet

Technical drawing



Cooking range water gas 2 zones

Model

SAP Code

00013585

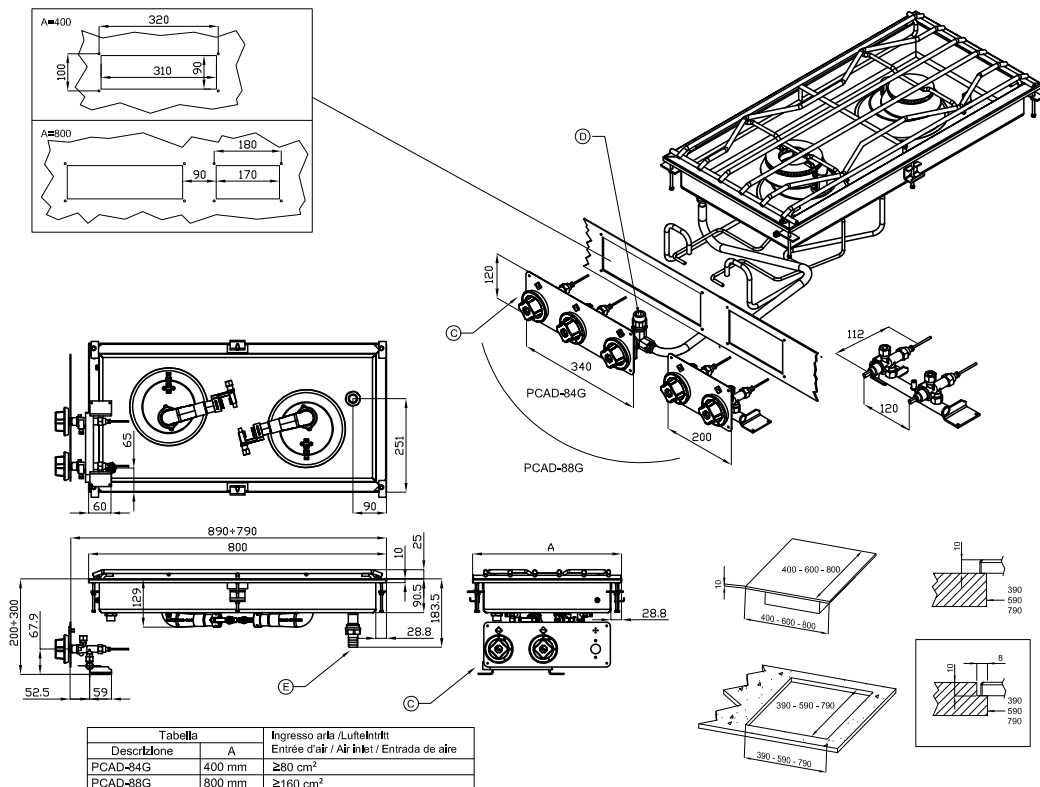

A	Data plate		C	Gas connection	ISO 7-1 1/2" M
D	Cold water connection	ISO 7-1 3/4" M	E	Water drainage	Ø25mm

# Technical data sheet

Technical parameters



## Cooking range water gas 2 zones

**Model**

**SAP Code**

00013585

**1. SAP Code:**

00013585

**2. Net Width [mm]:**

400

**3. Net Depth [mm]:**

800

**4. Net Height [mm]:**

120

**5. Net Weight [kg]:**

47.00

**6. Gross Width [mm]:**

430

**7. Gross depth [mm]:**

970

**8. Gross Height [mm]:**

540

**9. Gross Weight [kg]:**

55.00

**10. Device type:**

Gas unit

**11. Construction type of device:**

Drop-in

**12. Power gas [kW]:**

14.000

**13. Ignition:**

Eternal flame

**14. Material:**

Stainless steel

**15. Number of zones:**

2

**16. Power consumption of the zone 1 [kW]:**

8,5

**17. Power consumption of the zone 2 [kW]:**

5,5

**18. Power control type:**

knob control

**19. Additional information:**

Water level under the burners for easy cleaning  
water outlet  
water filling tap

**20. Number of burners/hot plates:**

2